

766080 BOQUILLA OJIVA REDUCIDA ISO 228 GAS CILÍNDRICO



Boquilla OJIVA REDUCIDA ISO 228 GAS CILÍNDRICO

Material: Aisi 316L (1.4404)

A pedido:

M.O.C.A. CE 1935/2004

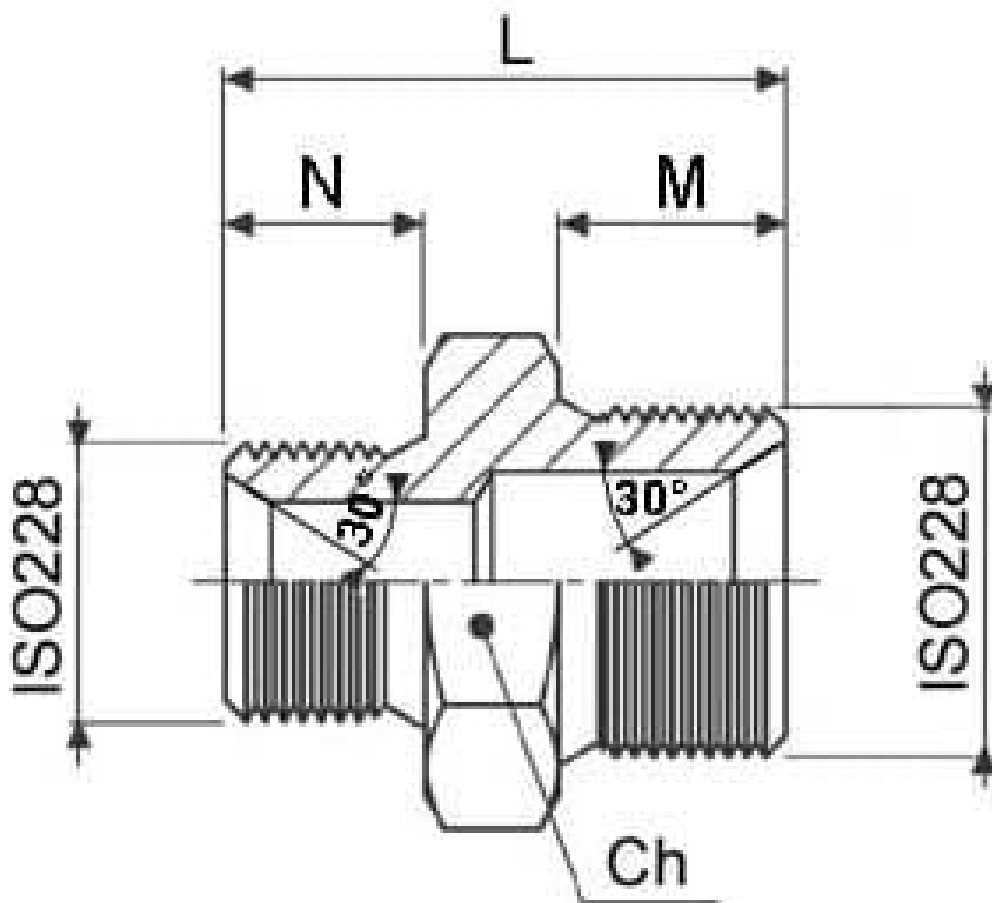

| ISO 228 | M | N | Ch | L | Kg | CÓDIGO AISI 316 |
|---------------|----|----|----|----|--------|-----------------|
| 1/4" x 1/8" | 11 | 8 | 19 | 26 | 0.041 | 766080 60500 |
| 3/8" x 1/8" | 13 | 8 | 22 | 29 | 0.040 | 766080 61300 |
| 3/8" x 1/4" | 13 | 11 | 22 | 32 | 0.0422 | 766080 61500 |
| 1/2" x 1/4" | 15 | 11 | 27 | 35 | 0.067 | 766080 61800 |
| 1/2" x 3/8" | 15 | 13 | 27 | 37 | 0.072 | 766080 62000 |
| 5/8"x1/2" | 15 | 15 | 27 | 39 | 0.085 | 766080 62300 |
| 3/4" x 1/4" | 17 | 11 | 32 | 38 | 0.102 | 766080 63100 |
| 3/4" x 3/8" | 17 | 13 | 32 | 40 | 0.106 | 766080 63300 |
| 3/4" x 1/2" | 17 | 15 | 32 | 42 | 0.110 | 766080 63500 |
| 1" x 1/2" | 19 | 15 | 41 | 48 | 0.214 | 766080 64200 |
| 1" x 3/4" | 19 | 17 | 41 | 50 | 0.318 | 766080 64500 |
| 1"1/4 x 3/4" | 21 | 17 | 50 | 52 | 0.318 | 766080 65800 |
| 1"1/4 x 1" | 21 | 19 | 50 | 54 | 0.320 | 766080 66000 |
| 1"1/2 x 3/4" | 22 | 17 | 55 | 53 | 0.434 | 766080 66300 |
| 1"1/2 x 1" | 22 | 19 | 55 | 55 | 0.438 | 766080 66400 |
| 1"1/2 x 1"1/4 | 22 | 21 | 55 | 57 | 0.430 | 766080 67000 |
| 2" x 1"1/4 | 25 | 20 | 70 | 64 | 0.680 | 766080 67500 |
| 2" x 1"1/2 | 25 | 22 | 70 | 66 | 0.708 | 766080 68000 |

