

## 744110 MANGA HEMBRA ISO 228 GAS + HEMBRA NPT

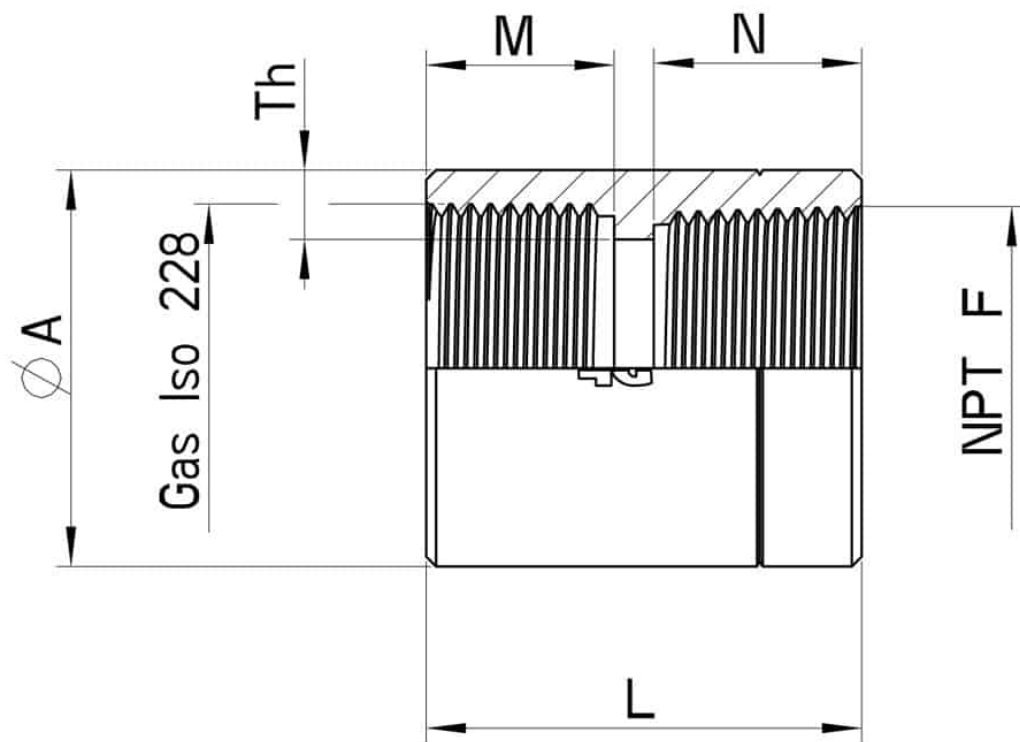

Manga ISO 228 Hembra GAS + Hembra NPT  
Material: AISI 316L (1.4404)

Bajo demanda:  
M.O.C.A. CE 1935/2004



| GAS ISO 228 x NPT F | Ø A x Th  | M  | N  | L  | Kg.   | CÓDIGO AISI 316 |
|---------------------|-----------|----|----|----|-------|-----------------|
| 1/8" x 1/8"         | 18 x 4,5  | 10 | 8  | 25 | 0,035 | 744110 60200    |
| 1/4" x 1/4"         | 22 x 6    | 15 | 15 | 32 | 0,067 | 744110 60600    |
| 3/8" x 3/8"         | 25 x 6,5  | 17 | 17 | 36 | 0,087 | 744110 61200    |
| 1/2" x 1/2"         | 30 x 7,25 | 18 | 19 | 40 | 0,137 | 744110 61900    |
| 3/4" x 3/4"         | 35 x 7,5  | 18 | 21 | 42 | 0,264 | 744110 62900    |
| 1" x 1"             | 40 x 7    | 19 | 21 | 44 | 0,264 | 744110 63900    |



