

790050_DOUBLE EFFECT PNEUMATIC ACTUATOR_INOX



*A richiesta con finitura a specchio
On request mirror finish*

COMPANY WITH
QUALITY SYSTEM
CERTIFIED BY DNV
- ISO 9001 -



DOUBLE EFFECT PNEUMATIC ACTUATOR IN ALUMINIUM NICKEL - 90°

- Forged Stainless Steel type A182 - F316 - EN 10088/3 - 1.4401 Body, inside surface finish (Ra 0,4 - 0,6 um) to minimize friction and maximize the actuator's life.
- ENAB 46100 T6 die-casted Aluminium alloy Pistons, Anodizing.
- Micro-casted Stainless Steel type A182 - F316 - EN 10088/3 - 1.4401 Covers.
- Forged Stainless Steel type AISI 316 (A4) Shaft.
- Screws in Stainless Steel AISI 316 (A4).
- Seals in nitrile nubber NBR.
- Acetalic resin + 20% PTFE Bearings, made by low friction coefficient material to avoid "metal to metal" contact, easely replaceable for maintenance.
- High performances Syntetic Grease.
- Double lower drilling for valve fastening and centering according to ISO 5211-DIN 3337 standards.
- Lower female shaft key according to ISO 5211-DIN 3337 standards to assembly on valves with square key on line and 45° shaft.
- Solenoid connections according to NAMUR VDIVDE-3845 standards.
- Top drilling for accessories fastening, and upper shaft end according to NAMUR VDIVDE-3845 standards.
- 3D position indicator.
- Adhesive nameplates with progressive serial number punched.
- The lubrication carried out by the manufacturer is guaranted for min. 1.000.000 operations.
- Running test and 100% seal test carried out with electronic equipment and certification of each individual product.
- According to ATEX 2014/34/UE Standard for explosive environnement; STANDARD version actuator: I M2 - II 2GD c Tmax = 95°C.
- According to EN 15714-3 design and manufacture standard requirements.
- EN 60529\A1 - Protection degree of casings IP 67.

USE  GHIDINI S.r.l.

AIR SUPPLY: dry or lubricated filtered compressed air.

TEMPERATURE RANGE: -20°+80°C

FEEDING PRESSURE: 1 bar minimum - 8 bar/120 psi maximum.

STANDARD ROTATION: counterclockwise.

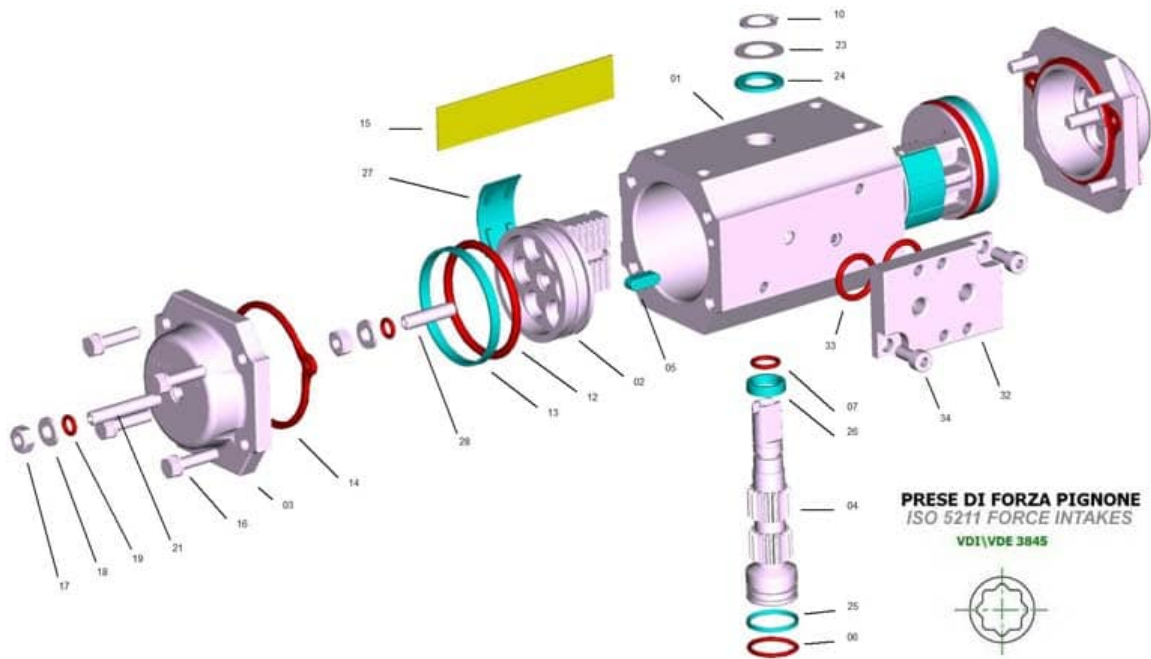

POSITION	AP 042	AP 050	AP 063	AP 075	AP 085	AP 100	AP 115	AP 125
A-90°	140	139	152	205	230	275	307	359
B	57	67	83	100	110	125	142	155
C	71	79	103	118	128	145	166	178
L	30,5	41,5	41,5	49	54	62,5	73	79
M	40,5	51,5	61,5	69	74	82,5	93	99
Port.A-Port.B NAMUR	1/8" GAS	1/8" GAS	1/4" GAS	1/4" GAS	1/4" GAS	1/4" GAS	1/4" GAS	1/4" GAS
N x O	8 x 12	8 x 12	8 x 12	14 x 18	14 x 18	14 x 18	27 x 36	27 x 36
P	20	20	20	20	20	20	30	30
Q x I	11 x 13	11 x 13	14 x 16	17 x 20	17 x 20	22 x 25	22 x 25	27 x 30
F.ISO 5211	F03 / 05	F03 / 05	F03 / 05	F05 / 07	F05 / 07	F07 / 10	F07 / 10	F07 / 10

