

## 373001\_L\_3 SEALS STANDARD SEALS - ISO 228 F



THREE-way ball valve three seals with "L" port  
Drive: ISO 5211 - DIN 3337 flange for actuator  
Connection: ISO 228 female/female/female thread  
Flow: Full  
Material: Aisi 304L (1.4307) - Aisi 316L (1.4404)  
Measure: from 2"1/2 to 4"  
Seals: Modified Virgin P.T.F.E.  
Operating temperature: -20°C+170°C  
Outer finish: Polished

On request:

Antistatic device ATEX:

II 2G Ex h IIC T4 Gb

II 2D Ex h IIIC T135°C Db

M.O.C.A. CE 1935/2004

• Seals made of:

PTFE with glass -20°C+170°C

PTFE with carbographite -20°C+180°C

PTFE with inox -20°C+200°C

UHMW High-molecular weight polyethylene -20°C+80°C

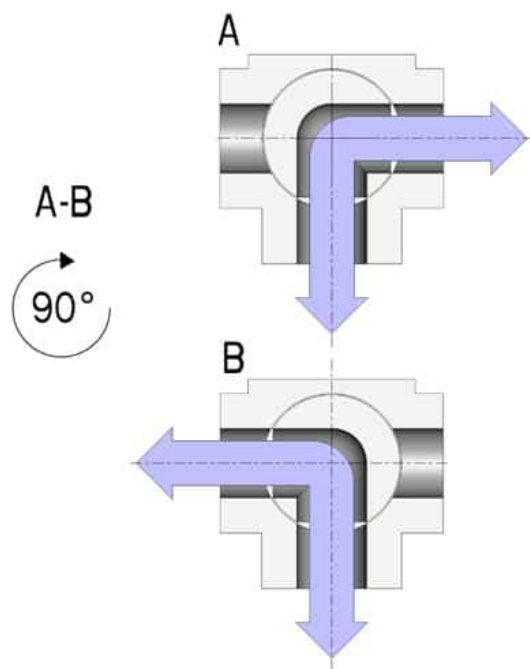

| G     | DN  | L   | I  | H     | PN | Kg    | ISO-DIN | Ø a | b  | Ø c x o | □  | d  | e   | f  | n° 4 Bolts | Nm  | CODE AISI 304L  | CODE AISI 316L  |
|-------|-----|-----|----|-------|----|-------|---------|-----|----|---------|----|----|-----|----|------------|-----|-----------------|-----------------|
| 2"1/2 | 65  | 160 | 22 | 101,5 | 16 | 8,88  | F.07    | 90  | 12 | 55x4    | 17 | 15 | 70  | 9  | M8x20      | 60  | -               | 373001<br>64410 |
| 2"1/2 | 65  | 160 | 22 | 101,5 | 16 | 9,35  | F.10    | 125 | 12 | 70x4    | 22 | 18 | 102 | 11 | M10x25     | 60  | -               | 373001<br>6441F |
| 3"    | 80  | 200 | 26 | 116   | 16 | 17,10 | F.07    | 90  | 12 | 55x4    | 17 | 15 | 70  | 9  | M8x20      | 75  | 373001<br>44810 | 373001<br>64810 |
| 3"    | 80  | 200 | 26 | 116   | 16 | 17,50 | F.10    | 120 | 12 | 70x4    | 22 | 18 | 102 | 11 | M10x25     | 75  | 373001<br>4481F | 373001<br>6481F |
| 4"    | 100 | 240 | 26 | 131   | 10 | 27,10 | F.07    | 90  | 12 | 55x4    | 17 | 15 | 70  | 9  | M8x20      | 110 | 373001<br>45410 | 373001<br>65410 |
| 4"    | 100 | 240 | 26 | 131   | 10 | 27,60 | F.10    | 125 | 12 | 70x4    | 22 | 18 | 102 | 11 | M10x25     | 110 | 373001<br>4541F | 373001<br>6541F |

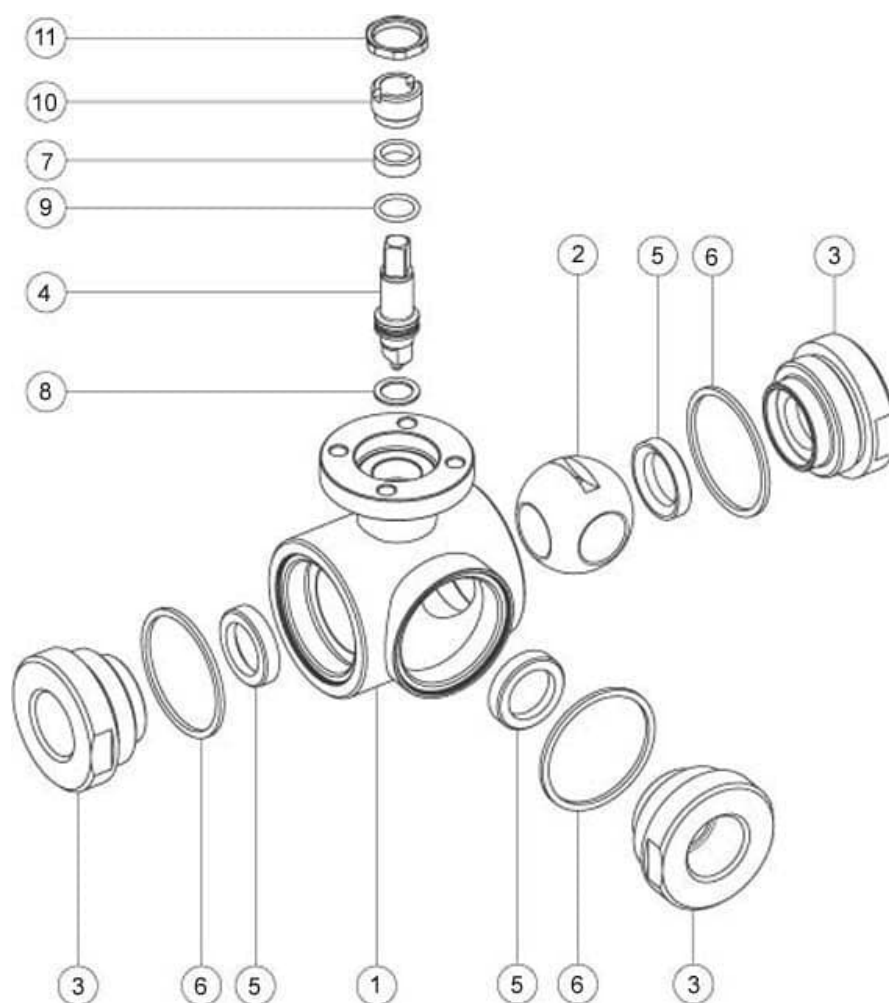

| POS. | Denomination  | PCS | MAT.            |
|------|---------------|-----|-----------------|
| 1    | Body          | 1   | AISI 316L       |
| 2    | Ball          | 1   | AISI 316L       |
| 3    | Sleeves       | 3   | AISI 316L       |
| 4    | Stem          | 1   | AISI 316L       |
| 5    | Ball Seals    | 3   | PTFE            |
| 6    | Sleeve Seals  | 3   | NBR             |
| 7    | Stem Seal     | 1   | PTFE            |
| 8    | Stem Seal     | 1   | PTFE            |
| 9    | Stem or-Seal  | 1   | FKM             |
| 10   | Register ring | 1   | AISI 304L (303) |
| 11   | Locknut       | 1   | AISI 303        |

