

766090 ISO 228 ZYLINDRISCHES GAS SPITZBOGEN NIPPEL X ISO 7  
KONISCHES GAS REDUZIERUNG

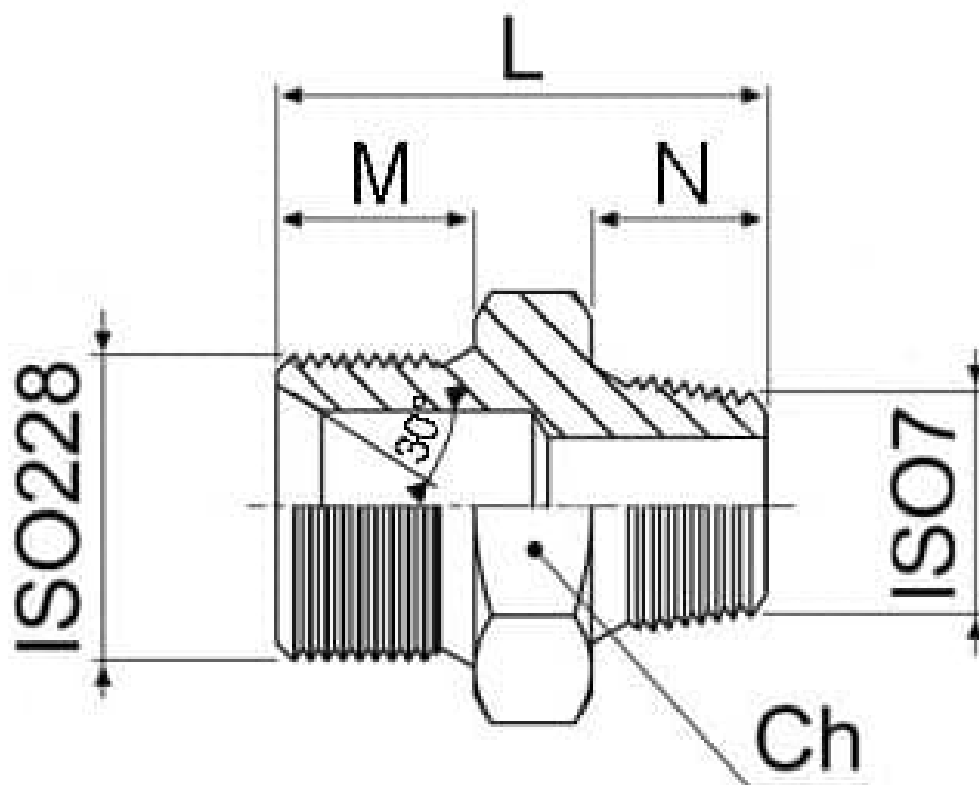

ISO 228 ZYLINDRISCHES GAS SPITZBOGEN Nippel x ISO 7 KONISCHES GAS Reduzierung  
Material: Aisi 316L (1.4404)

Auf Anfrage:  
M.O.C.A. CE 1935/2004



ISO 228 x ISO7	M	N	Ch	L	Kg	CODE AISI 316L
1/4" x 1/8"	11	10	19	28	0.025	766090 60500
3/8" x 1/8"	13	10	22	31	0.039	766090 61300
3/8" x 1/4"	13	11	22	31	0.045	766090 61500
1/2" x 1/4"	15	11	27	35	0.069	766090 61800
1/2" x 3/8"	15	13	27	37	0.0715	766090 62000
3/4" x 1/4"	17	11	32	38	0.102	766090 63100
3/4" x 3/8"	17	13	32	40	0.109	766090 63300
3/4" x 1/2"	17	15	32	42	0.115	766090 63500
1" x 1/2"	19	15	41	46	0.200	766090 64200
1" x 3/4"	19	17	41	48	0.210	766090 64500
1"1/4 x 3/4"	21	17	50	52	0.320	766090 65800
1"1/4 x 1"	21	19	50	54	0.345	766090 66000
1"1/2 x 3/4"	22	17	55	53	0.401	766090 66200
1"1/2 x 1"	22	19	55	55	0.440	766090 66400
1"1/2 x 1"1/4	22	21	55	57	0.440	766090 67000
2" x 1"1/4	25	21	70	65	0.680	766090 67500
2" x 1"1/2	25	22	70	66	0.660	766090 68000



