

763028 GAS ISO 228 SCHLAUCHHALTER

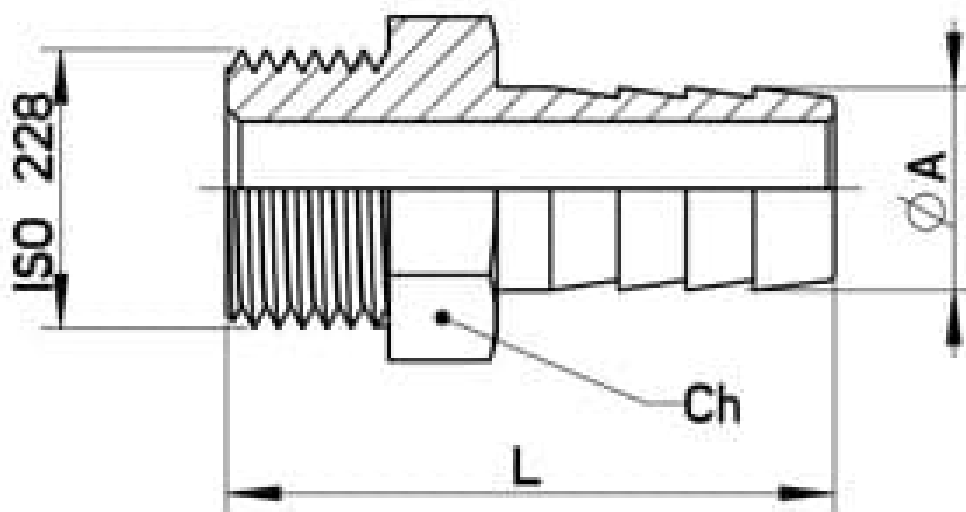

GAS ISO 228 Schlauchhalter
Material: Aisi 316L (1.4404)

Auf Anfrage:
M.O.C.A. CE 1935/2004



ISO 228	Ø A	Ch.	L	Kg	CODE AISI 304L	CODE AISI 316L
1/8"	6	14	30	0.012	-	763028 60200
1/4"	6	14	30	0.016	-	763028 61100
1/4"	8	14	36	0.018	-	763028 61700
1/4"	10	14	36	0.023	-	763028 62000
1/4"	12	14	36	0.020	-	763028 62300
1/4"	14	17	41	0.030	-	763028 62400
1/4"	13	14	36	0.023	-	763028 62500
3/8"	8	17	38	0.030	-	763028 62900
3/8"	8,5	17	38	0.031	-	763028 63000
3/8"	10,5	17	38	0.034	-	763028 63100
3/8"	10	17	38	0.033	-	763028 63200
3/8"	12	17	38	0.032	-	763028 63500
3/8"	14	17	38	0,034	-	763028 63600
3/8"	17	19	38	0,048	-	763028 63800
3/8"	19	22	42	0,062	-	763028 63900
1/2"	10	22	42	0.06	-	763028 64100
1/2"	13	22	45	0.064	-	763028 64400
1/2"	15	22	45	0.0610	-	763028 64600
1/2"	17	22	45	0.070	-	763028 64700
1/2"	19	22	50	0.052	-	763028 64900
1/2"	21	22	50	0,065	-	763028 65000
3/4"	16	27	51	0.116	-	763028 651000
3/4"	19	27	56	0.112	-	763028 65300
3/4"	21	27	56	0.117	-	763028 65400
3/4"	25	27	56	0.116	-	763028 65700
1"	19	36	60	0.174	-	763028 66200
1"	25	36	65	0.189	-	763028 66500
1"	32	36	65	0.195	-	763028 66700
1"1/4"	38	46	75	0,330	-	763028 67000
1"1/2"	40	50	80	0.488	763028 47500	763028 67500
1"1/2"	45	50	80	0.450		763028 67700
1"1/2"	50	52	80	0.431	763028 48000	763028 68000
2"	50	62	85	0.695	763028 48300	763028 68300
2"	60	62	90	0.614	763028 48400	763028 68400
2"1/2"	50	78	95	-	-	763028 68600
2"1/2"	60	78	100	-	-	763028 68800
2"1/2"	70	78	110	-	-	763028 69000
2"1/2"	80	82	110	-	-	763028 69200
3"	75	90	115	-	-	763028 69500

