

744110 INNENGEWINDE ISO 228 GAS MUFFE+ INNENGEWINDE NPT

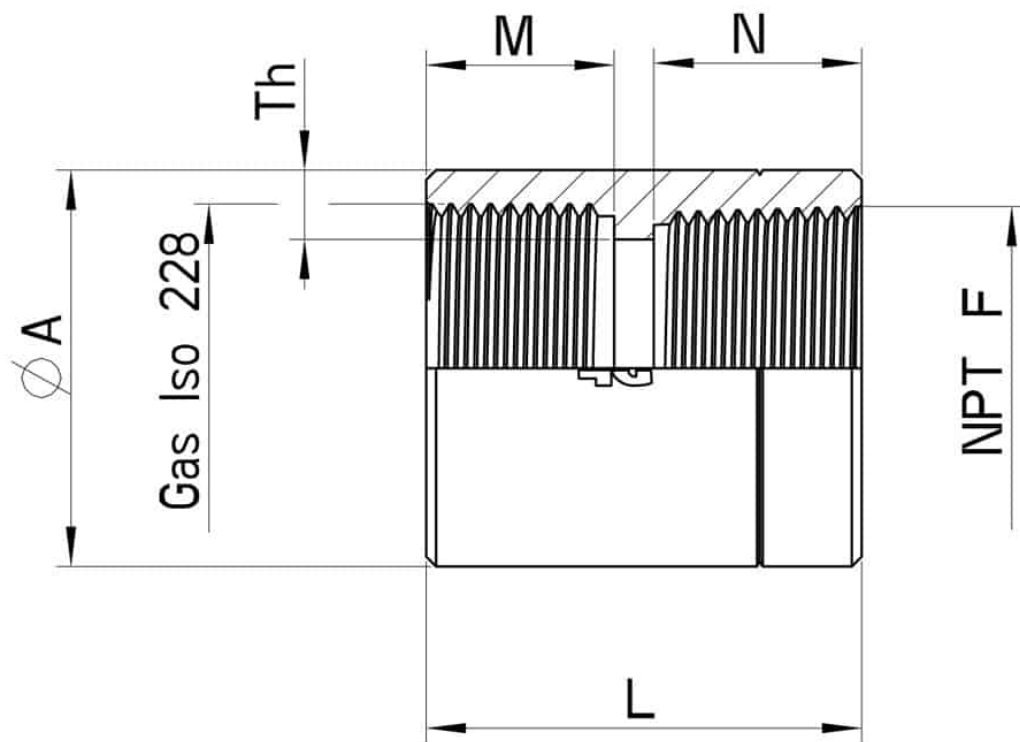

Innengewinde ISO 228 GAS Muffe + Innengewinde NPT
Material: Aisi 316L (1.4404)

Auf Anfrage:
M.O.C.A. CE 1935/2004



GAS ISO 228 x NPT F	Ø A x Th	M	N	L	Kg.	CODE AISI 316L
1/8" x 1/8"	18 x 4,5	10	8	25	0,035	744110 60200
1/4" x 1/4"	22 x 6	15	15	32	0,067	744110 60600
3/8" x 3/8"	25 x 6,5	17	17	36	0,087	744110 61200
1/2" x 1/2"	30 x 7,25	18	19	40	0,137	744110 61900
3/4" x 3/4"	35 x 7,5	18	21	42	0,264	744110 62900
1" x 1"	40 x 7	19	21	44	0,264	744110 63900

