

103026C STANDARD DICHTUNG - I/A DIN 11851 - HEIZMANTEL

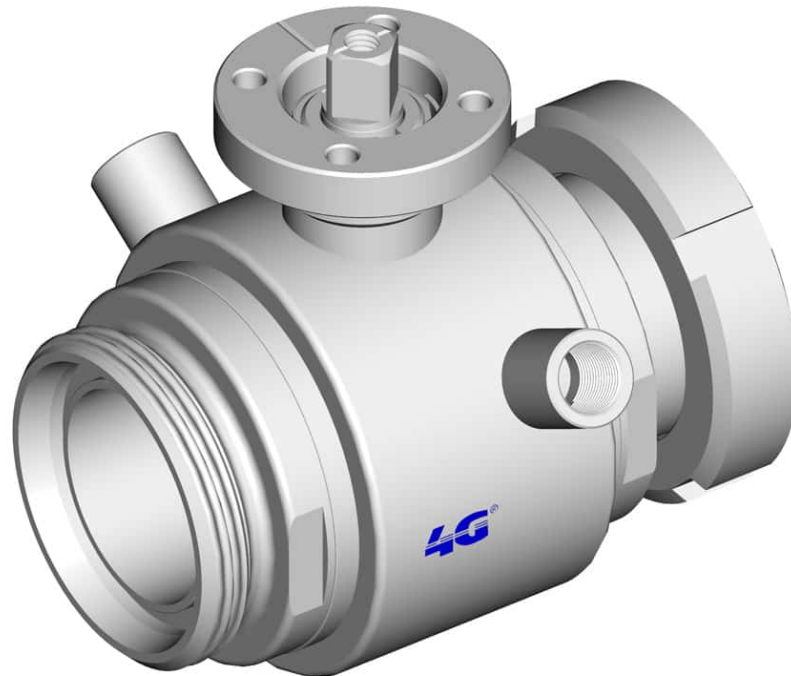

ZWEI Wege Kugelhahn mit HEIZMANTEL
Bedienelement: Flansch für Antrieb ISO 5211 - DIN 3337
Anschlüsse: Innengewinde/Außengewinde DIN 11851
Durchgang: Voll
Material: Aisi 304L (1.4307) - Aisi 316L (1.4404)
Abmessungen: von DN25 bis DN100
Dichtungen: Rein Modifiziert PTFE
Betriebstemperatur: -20°C+170°C
Oberflächenbehandlung: Poliert
Einschließlich Schrauben für Antriebsmontage

Auf Anfrage:

Antistatische Vorrichtung ATEX:

II 2G Ex h IIC T4 Gb

II 2D Ex h IIIC T135°C Db

M.O.C.A. CE 1935/2004

• Dichtungen aus:

PTFE mit Glas -20°C+170°C

PTFE mit Carbogرافit -20°C+180°C

PTFE mit Inox -20°C+200°C

UHMW Polyethylen mit hoher Dichte -20°C+80°C

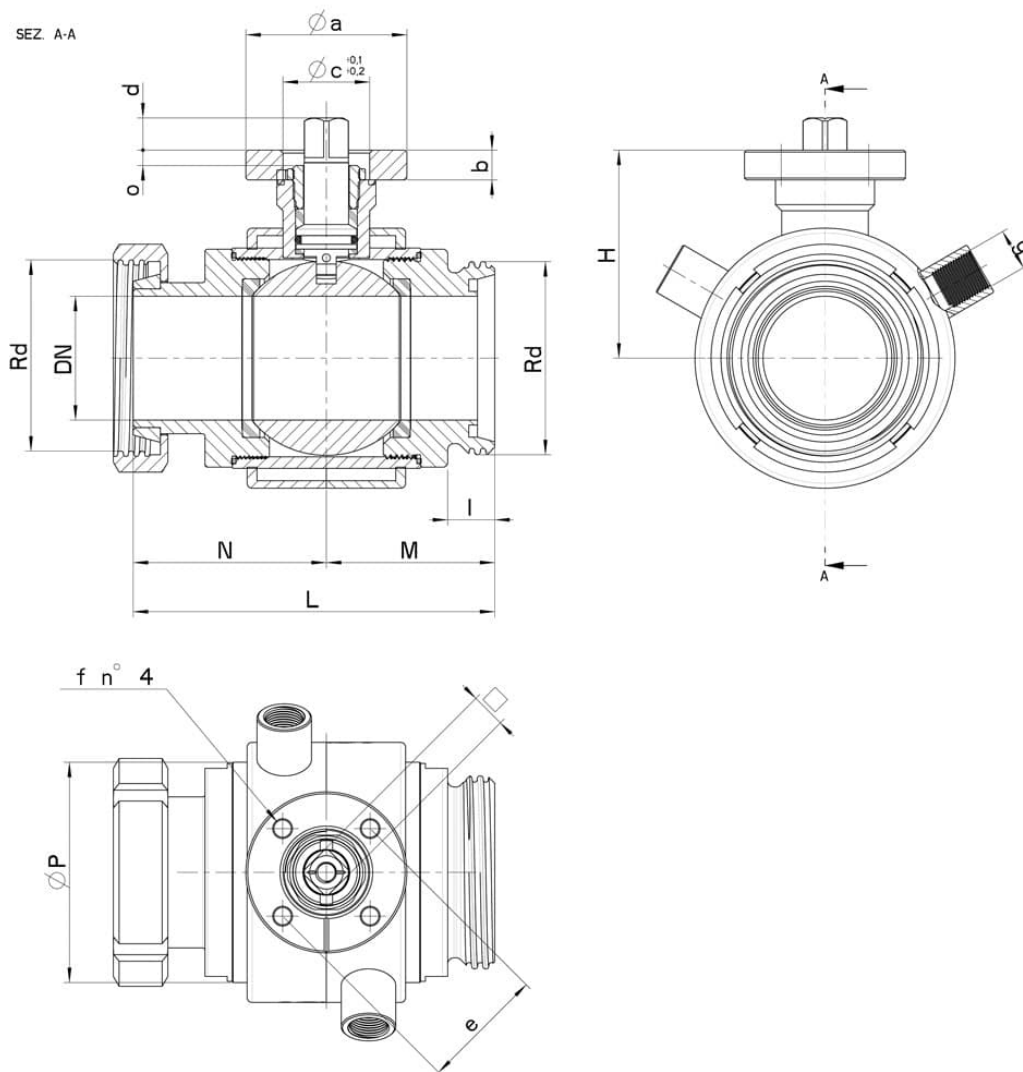

| DN | Rd | L | M | N | I | H | Ø P | g | PN | Kg | ISO-DIN | Ø a | b | Ø c x o | □ | d | e | f | n° 4 Schrauben | Nm | CODE AISI 304L | CODE AISI 316L |
|-----|------------------|-----|----|-----|----|------|-----|------|----|------|---------|-----|----|---------|----|----|-----|----|-------------------|----|----------------|--|
| 25 | 52 x 1/6" | 115 | 53 | 62 | 14 | 51,5 | 52 | 1/4" | 64 | - | F.04 | 54 | 9 | 30x3 | 11 | 10 | 42 | 6 | M5x16 | 15 | - | 103026C62610  |
| 25 | 52 x 1/6" | 115 | 53 | 62 | 14 | 51,5 | 52 | 1/4" | 64 | - | F.05 | 65 | 9 | 35x3 | 14 | 13 | 50 | 7 | M6x16 | 15 | - | 103026C6261F |
| 32 | 58 x 1/6" | 121 | 56 | 65 | 14 | 56,5 | 60 | 1/4" | 64 | - | F.04 | 54 | 9 | 30x3 | 11 | 10 | 42 | 6 | M5x16 | 18 | - | 103026C63010 |
| 32 | 58 x 1/6" | 121 | 56 | 65 | 14 | 56,5 | 60 | 1/4" | 64 | - | F.05 | 65 | 9 | 35x3 | 14 | 13 | 50 | 7 | M6x16 | 18 | - | 103026C6301F |
| 40 | 65 x 1/6" | 135 | 63 | 72 | 14 | 76 | 73 | 3/8" | 64 | - | F.05 | 65 | 12 | 35x4 | 14 | 13 | 50 | 7 | M6x20 | 25 | - | 103026C63410 |
| 40 | 65 x 1/6" | 135 | 63 | 72 | 14 | 76 | 73 | 3/8" | 64 | - | F.07 | 90 | 12 | 55x4 | 17 | 15 | 70 | 9 | M8x20 | 25 | - | 103026C6341F |
| 50 | 78 x 1/6" | 146 | 68 | 78 | 14 | 84 | 88 | 3/8" | 40 | 4,84 | F.05 | 65 | 12 | 35x4 | 14 | 13 | 50 | 7 | M6x20 | 30 | - | 103026C63810 |
| 50 | 78 x 1/6" | 146 | 68 | 78 | 14 | 84 | 88 | 3/8" | 40 | 4,94 | F.07 | 90 | 12 | 55x4 | 17 | 15 | 70 | 9 | M8x20 | 30 | - | 103026C6381F |
| 65 | 95 x 1/6" | 163 | 77 | 86 | 16 | 94,5 | 113 | 1/2" | 40 | 8,10 | F.07 | 90 | 12 | 55x4 | 17 | 15 | 70 | 9 | M8x20 | 45 | - | 103026C64410 |
| 65 | 95 x 1/6" | 163 | 77 | 86 | 16 | 94,5 | 113 | 1/2" | 40 | - | F.10 | 125 | 12 | 70x4 | 22 | 18 | 102 | 11 | M10x25 | 45 | - | 103026C6441F |
| 80 | 110 x 1/4" | 189 | 92 | 97 | 20 | 106 | 135 | 1/2" | 40 | - | F.07 | 90 | 12 | 55x4 | 17 | 15 | 70 | 9 | M8x20 | 70 | 103026C44810 | 103026C64810 |
| 80 | 110 x 1/4" | 189 | 92 | 97 | 20 | 106 | 135 | 1/2" | 40 | - | F.10 | 125 | 12 | 70x4 | 22 | 18 | 102 | 11 | M10x25 | 70 | 103026C4481F | 103026C6481F |
| 100 | 130 x 1/4" | 198 | 95 | 103 | 20 | 120 | 167 | 1/2" | 25 | - | F.07 | 90 | 12 | 55x4 | 17 | 15 | 70 | 9 | M8x20 | 80 | 103026C45410 | 103026C65410 |
| 100 | 130 x 1/4" | 198 | 95 | 103 | 20 | 120 | 167 | 1/2" | 25 | - | F.10 | 125 | 12 | 70x4 | 22 | 18 | 102 | 11 | M10x25 | 80 | 103026C4541F | 103026C6541F |

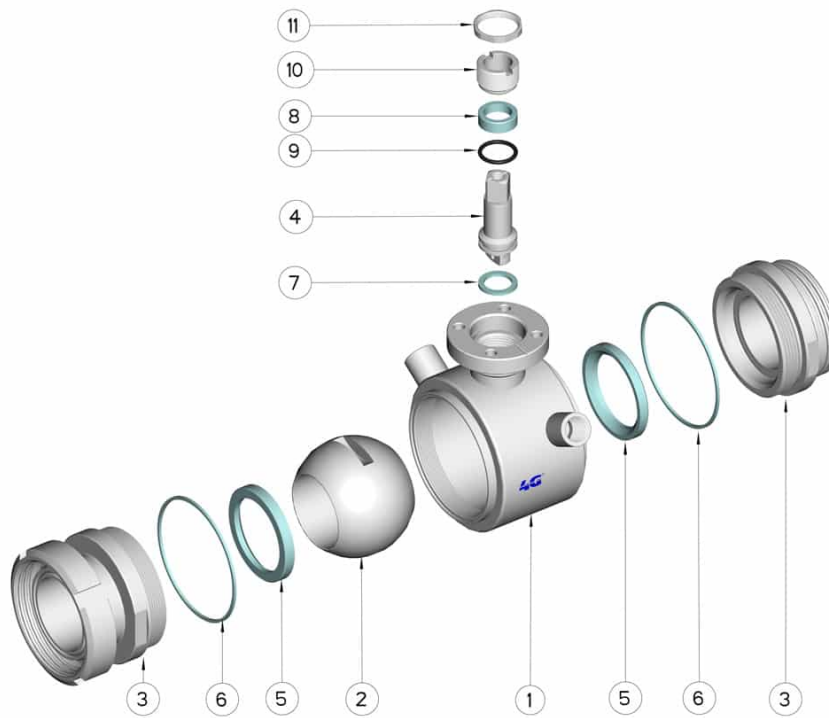

| POSITION | BEZEICHNUNG | STÜCKE | MATERIAL |
|----------|------------------|--------|---------------------------|
| 1 | Gehäuse | 1 | AISI (304L) 316L |
| 2 | Kugel | 1 | AISI (304L) 316L |
| 3 | Muffen | 2 | AISI (304L) 316L |
| 4 | Stift | 1 | AISI (304L) 316L |
| 5 | Kugeldichtungen | 2 | Modifiziertes junges PTFE |
| 6 | Muffendichtungen | 2 | PTFE |
| 7 | Stiftdichtung | 1 | PTFE |
| 8 | Stiftdichtung | 1 | PTFE |
| 9 | Stiftdichtung OR | 1 | FKM |
| 10 | Registerring | 1 | AISI 304L (303) |
| 11 | Kontermutter | 1 | AISI 303 |

